

USER MANUAL

WHAT'S IN THE BOX:

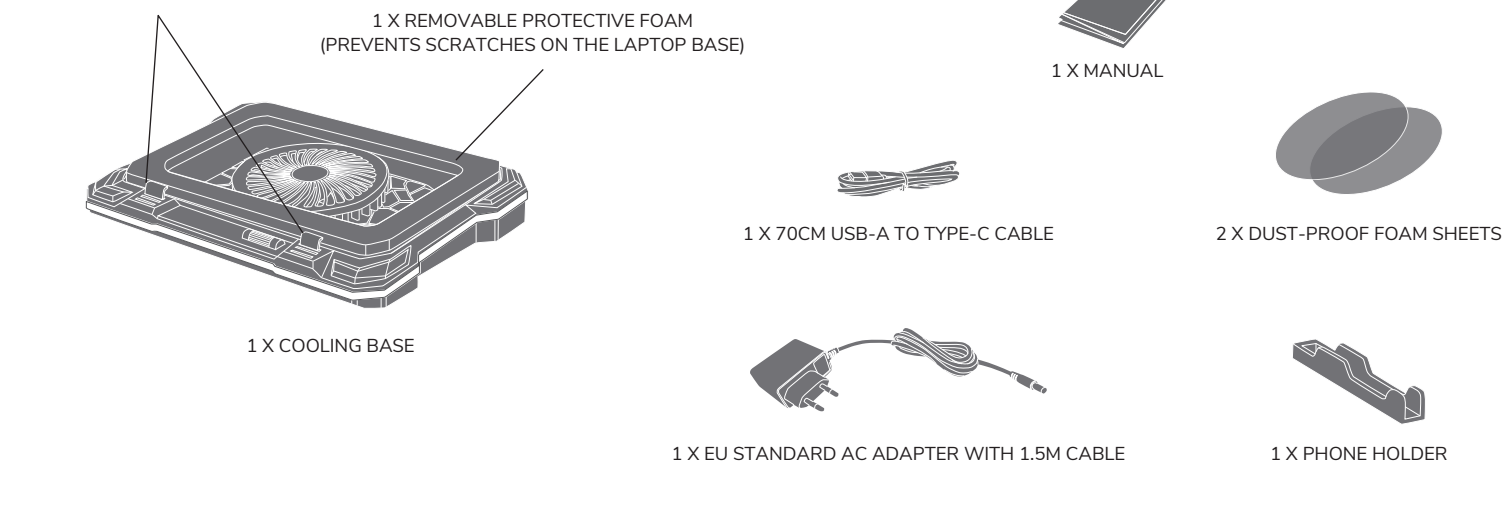

PRODUCT FEATURES

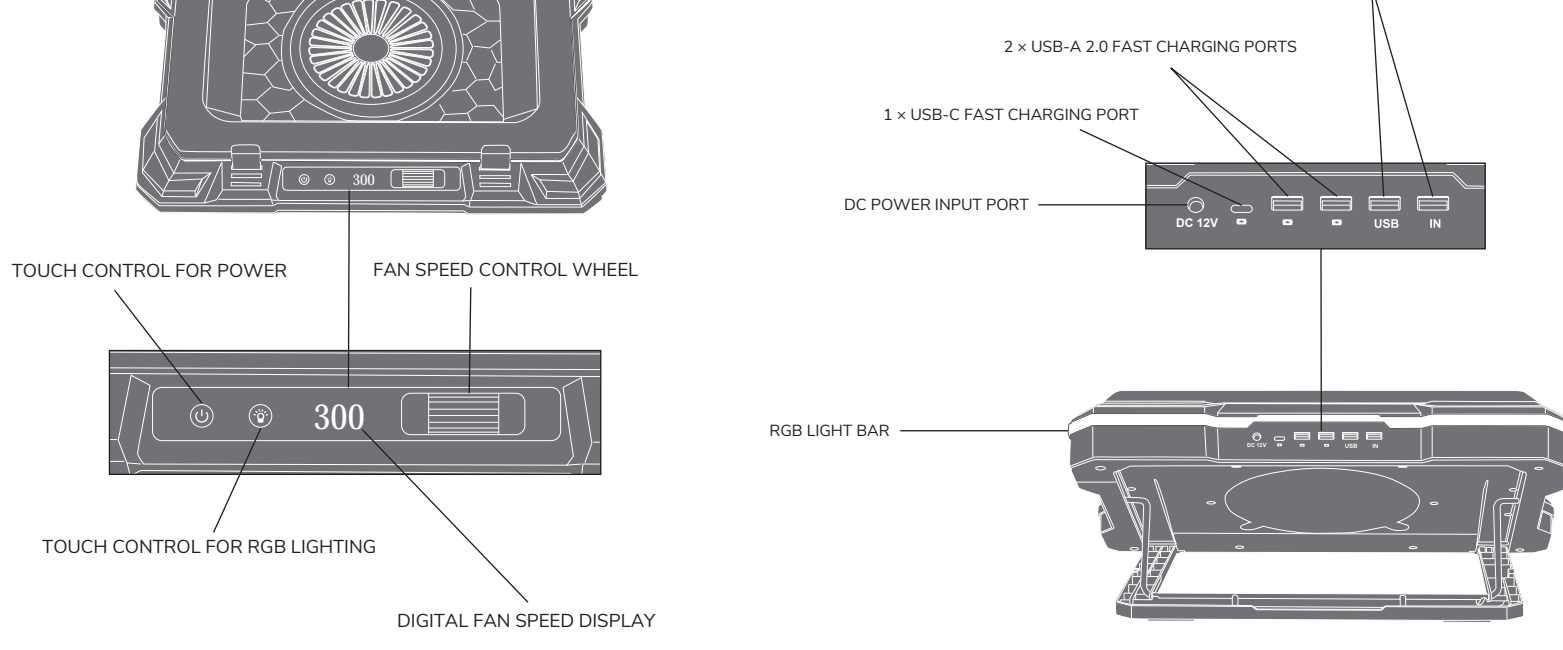

INSTALLATION & USAGE INSTRUCTIONS

1. Adjust the Stand.

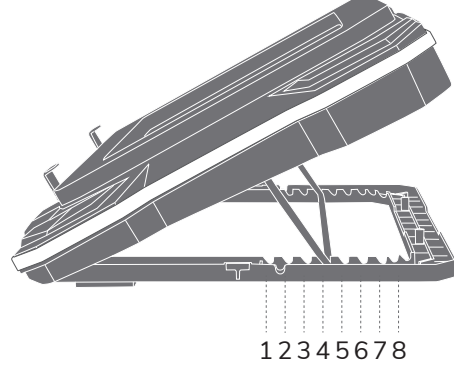

Tilt the cooling base to your preferred angle for comfort and airflow.

2. Set Up the Laptop.

- a. Make sure the protective foam is placed on the base.

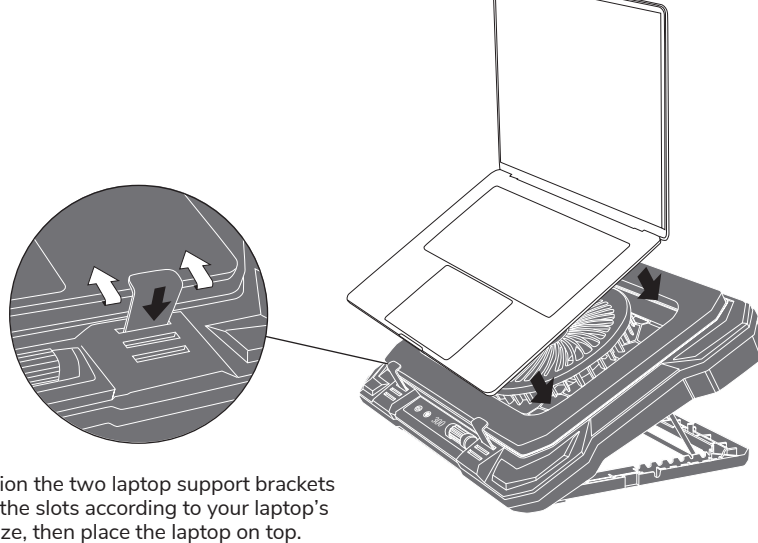

Position the two laptop support brackets into the slots according to your laptop's size, then place the laptop on top.

- b. Use the included USB-A to Type-C cable to connect the cooling base to your laptop. Once the laptop is successfully connected to the base, the RGB touchscreen, wind speed display, and fan will all turn on simultaneously.

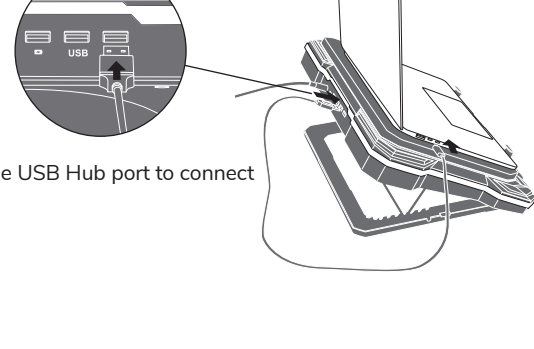

Use the USB Hub port to connect

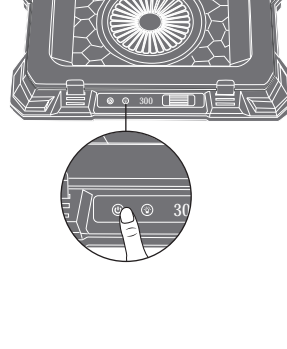

- Press the main power switch for 3 seconds to turn off the RGB touchscreen, wind speed display, and fan simultaneously.

- Press the main power switch for 3 seconds to turn on the RGB touchscreen, wind speed display, and fan simultaneously.

3. Attach the Phone Holder.

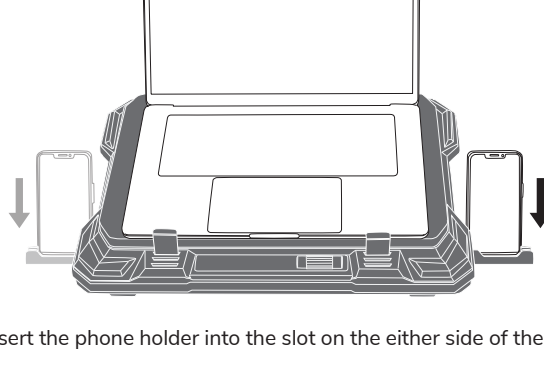

Insert the phone holder into the slot on the either side of the stand.

CHARGING FUNCTIONALITY

To enable fast charging, make sure to use a compatible fast charging cable and device.

Note: super charging cables are not included in the box.

How to charge:

1. Plug in the AC adapter and connect it to the DC port on the stand.

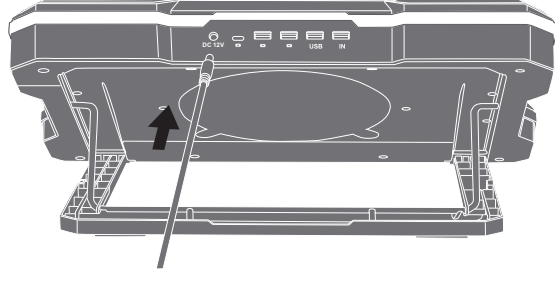

2. Plug your fast charging cable into one of the stand's charging ports (USB-A or USB-C), then connect your device.

Note: Fast charging cables are not included.

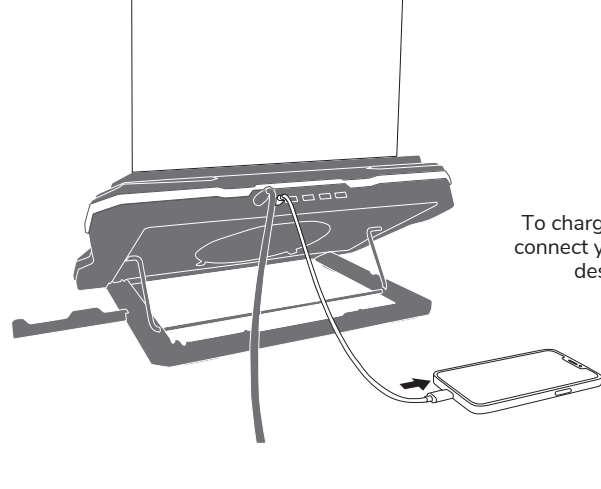

To charge your devices (e.g., smartphone), connect your own fast charging cable to the designated fast charging ports.

RGB LED LIGHT CONTROL

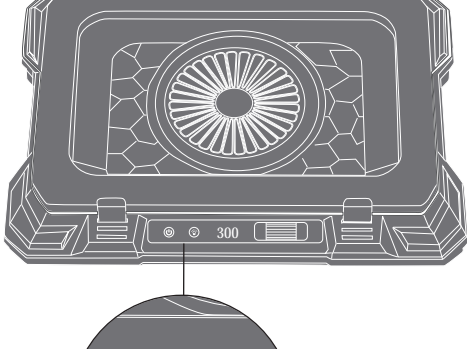

Available LED modes:

1. Slow colour flow
2. Fast colour flow
3. Solid colours: red, green, blue, cyan, purple
4. Quick breathing effect
5. Horse race lamp effect
6. Gradient flow

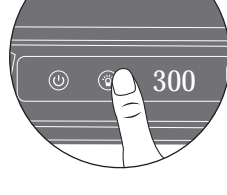

- Turn on LEDs: touch and hold the RGB touchpad for 3 seconds until the RGB bar lights up.
- Change lighting modes: tap the RGB touchpad to cycle through available lighting colours and effects.
- Turn off LEDs: press and hold the RGB touchpad for 3 seconds.

FAN SPEED CONTROL

- Adjustable across 20 levels
- Speed range: 300 – 2200 rpm
- Fan speed is displayed digitally on the screen

How to adjust:

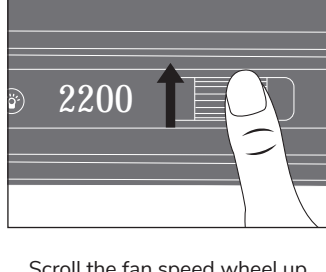

Scroll the fan speed wheel up to increase speed

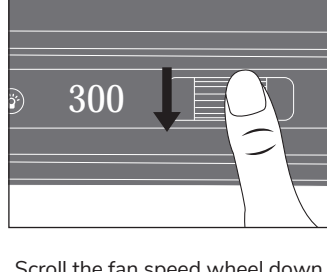

Scroll the fan speed wheel down to decrease speed

DUST-PROOF FOAM SHEET MAINTENANCE

To maintain optimal airflow and performance, it's recommended to replace the dust-proof foam sheet every 3–6 months.

Steps to replace:

1. Open the dust filter cover on the bottom of the cooling base.

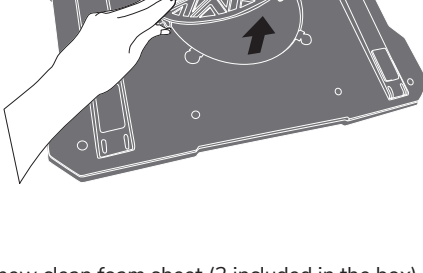

2. Remove the used dust-proof foam sheet.



3. Insert a new clean foam sheet (2 included in the box).

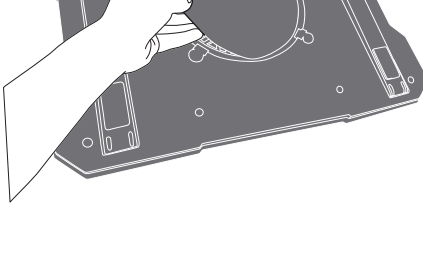

4. Reattach the dust filter cover securely.

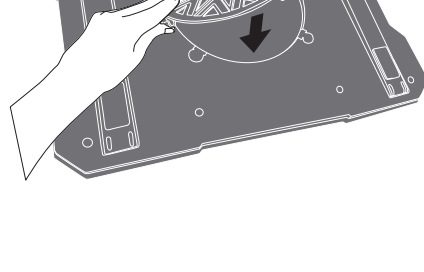

SPECIFICATIONS

Design and specifications are subject to change without notice.

Cable length: 70cm

Input: 12V / 3A

Output:

- Type-C Port: 15W

- USB Port: 10W x 2

Charging time: 3 – 4h

Fan Speed: 300-2200RPM ± 10%

Noise Level: 28-52dBA

Mass: Approx. 1200g

Size: 428 x 316 x 58 mm

Material: ABS + metal